

SLVB-76 is an uniquely designed vacuum breaker in stainless steel construction.



SIZE

Pipe Connection : 15NB

Air Connection : 6NB BSPT

PIPE CONNECTIONS

Screwed : BSP, BSPT, NPT

DESIGN CONDITIONS

- Max. Allowable Pressure
(PMA) - 49.6 Bar (g) @ Room Temp.
- Max. Allowable Temp
(TMA) - 538 °C
- Max. Operating Pressure
(PMO) - 24.4 Bar (g) @ 538 °C

CERTIFICATION

En 10204 - 3.1

UNIQUE FEATURES

- Stainless steel construction
- Robust design
- Testing 100% on steam

INSTALLATION

Vacuum breaker is to be installed in vertical position with the cap at the top with arrow mark shown on body from downward to upward

EXPLODED VIEW

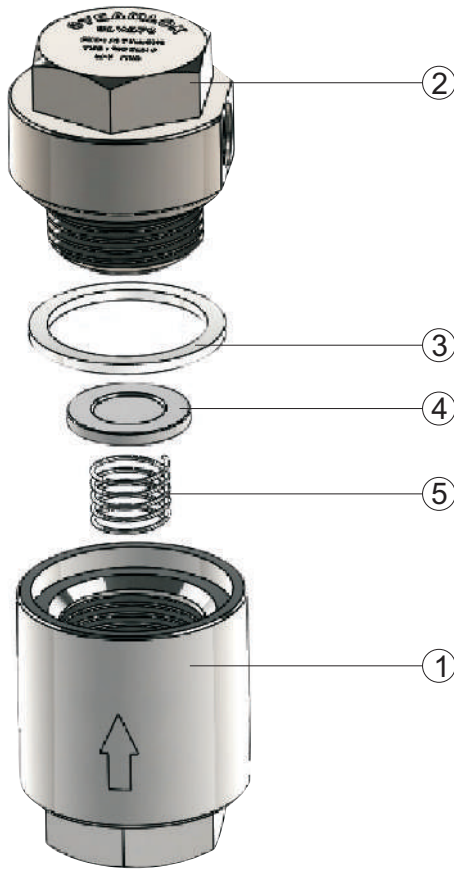

DIMENSIONAL VIEW

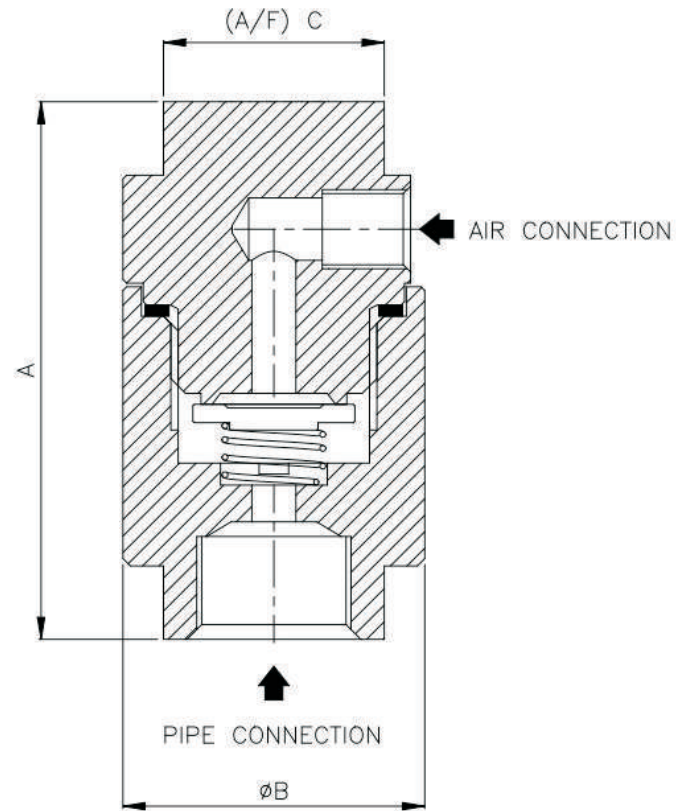

PART LIST

NO	DESCRIPTION	MATERIAL	QTY
01	BODY	AISI 304	1
02	CAP	AISI 304	1
03	CAP GASKET	GRAPHITE WITH AISI 304	1
04	DISC	AISI 316	1
05	SPRING	AISI 316	1

DIMENSIONAL TABLE

SLVB76	A (mm)	øB (mm)	(A/F) C (mm)	WT.(APPROX) (Kg)
15X6NB	73	41	30	0.580

HOW TO ORDER

Ex. SLVB76, Vacuum Breaker

15NB, Screwed BSPT, Non IBR.

SPARE PARTS

Cap gasket - Set of 5 nos.

SteamLok Engineering Pvt. Ltd.

W75 S Block MIDC Bhosari Pune, Maharashtra - 411026, India
Email : sales@steamlokengineering.com • Website : www.steamlokengineering.com

STEAM SOLUTION GROUP