

SLTT - 88 is Thermodynamic Steam Trap in Forged Alloy Steel construction, suitable for High Temp. & Pressure with maintainable seat & integral strainer design.



### UNIQUE FEATURES

- Maintainable seat design
- Special heat treatment (vacuum) for Seat & Disc
- Functional test - 100% on steam

### CONDENSATE DISCHARGE CAPACITY

Differential Pressure bar (g)	Kg / hr
8	65
25	138
50	168
75	185
100	198
125	212
150	223
175	234
200	246
225	256
250	265

### SIZE

15 NB, 20 NB, 25NB

### PIPE CONNECTIONS

**Socket Weld, Butt Weld**

**Flanged : ASA 600, ASA 1500**  
(Weld on)

### DESIGN CONDITIONS

- Max. allowable pressure (PMA) -  
250 bar (g) at 150°C
- Max. allowable temp (TMA) - 550°C at 124.9 bar (g)
- Minimum inlet pressure required - 8 bar (g)
- Back pressure should not exceed 60% of the inlet pressure
- Cold hydraulic test pressure - 375 bar (g)

### CERTIFICATION

IBR approval / En 10204 3.1

### INSTALLATION

- SLTT - 88 can be installed both vertically as well as horizontally with the pipe line. Recommended is, trap installation in a horizontal pipe with name plate at top.
- Cover nut checking & hot tightening is required after 24 hours of trap operation.
- Up stream & Down stream isolation valves are recommended for the trap.
- Ensure proper flushing of line before installation.

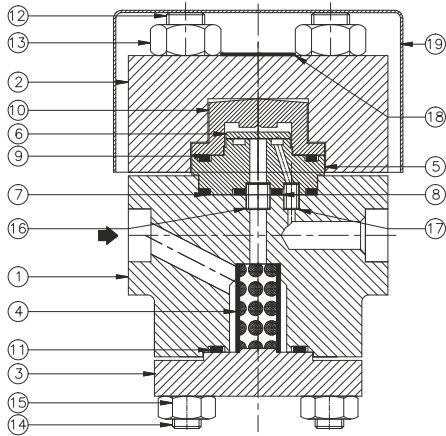
**CONSTRUCTION**

**PART LIST**

No.	Part Name	Material	Qty
1	Body	ASTM A 182 Gr. F91	1
2	Top cover	ASTM A 182 Gr. F91	1
3	Screen cap	ASTM A 182 Gr. F91	1
4	Screen	SS AISI 304 100 Mesh	1
5	Seat	ASTM A 681 Gr. D2	1
6	Disc	ASTM A 681 Gr. D2	1
7	Seat gasket lower - 1	Spiral wound SS 304 with graphite	1
8	Seat gasket lower - 2	Spiral wound SS 304 with graphite	1
9	Seat gasket upper	Spiral wound SS 304 with graphite	1
10	Disc Cover	AISI 420	1
11	Screen cap gasket	Spiral wound SS 304 with graphite	1
12	Stud for top cover	ASTM A 193 Gr. B16	4
13	Nut for Stud (M16)	ASTM A 194 Gr. 7	4
14	Stud for Screen Cap	ASTM A 193 Gr. B16	6
15	Nut for Stud (M12)	ASTM A 194 Gr. 7	6
16	Centre locator	AISI 304	1
17	Ferrule	AISI 304	1
18	Name plate	AISI 304	1
19	Insulation Cover	AISI 304	1

**DIMENSIONS**

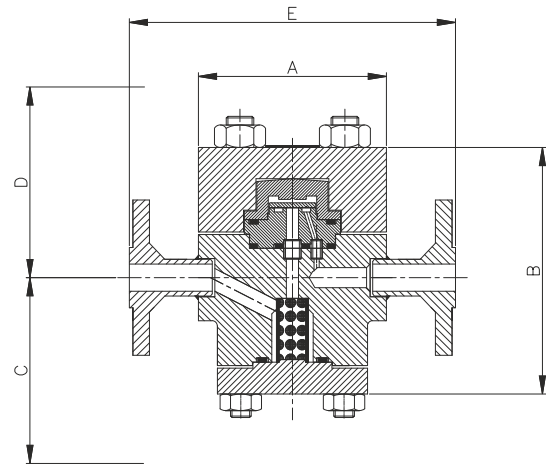
Socket weld, Butt weld &amp; Flanged connection



SLTT - 88	A	B	C	D	Wt.
SW-15,20,25NB	109	143	140	160	13.7 kg
BW-15,20,25NB	115	143	140	160	13.3 kg

**Flanged**

Model	Class	Size	E	Wt. (Approx)
SLTT - 88	# 600	15 NB	225	16.7 kg
		20 NB	215	17.5 kg
		25 NB	211	18.6 kg
	# 1500	15 NB	247	18.9 kg
		20 NB	244	20.0 kg
		25 NB	218	21.5 kg

Note : Insulation Cover is Optional

**SPARE PARTS**

- Seat & Disc Assembly (set P. No. 5,6,7,8,9,16,17)
- Screen (set of 5)
- Screen cap gasket (Set of 5)
- Insulation Cover (Set of 3)

**HOW TO ORDER**

Ex. SLTT - 88 Forged Alloy steel steam trap, 15NB socket weld connection, IBR.

**Steamlok Engineering Pvt. Ltd.**

W75 S Block MIDC Bhosari Pune, Maharashtra - 411026, India

Email : sales@steamlokengineering.com • Website : www.steamlokengineering.com

**STEAM SOLUTION GROUP**